

Saws and Swagers

Section 19



GENERAL INFORMATION

Hydraulink Fluid Connectors Ltd. are authorised distributors for Finn-Power swagers and cut-off saws. Finn-Power produce high-quality, extremely durable machines that are compact and ergonomically designed.

The swagers available through Hydraulink range from hand-operated portable machines for hoses up to 1" I.D. to large-scale production models with capacity up to 190mm. For more information regarding Finn-Power swagers not detailed in this section, visit <http://www.lillbacka.com/powerco/> or contact Hydraulink.

The most common machines are listed in this section, and the larger models are typically available in one of three control solutions, dependent upon the main type of application. Also listed are tool bases and die-change racks that further improve the ergonomics of the machines and can make them more productive.

Also included in this section are Finn-Power hose cut-off saws, which are manufactured to the same high standards as their swagers.

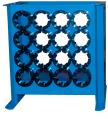
SWAGER BASES

QUICK-CHANGE BASE
FOR P20
XP20-QCB
Page 19 - 3



QUICK-CHANGE BASE
FOR P32
XP32-QCB
Page 19 - 3

SWAGERS



FINNPOWER P16
SWAGER
XP16
Page 19 - 3



FINNPOWER P20
SWAGER
XP20
Page 19 - 4

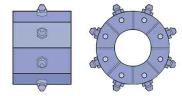

FINNPOWER P32
SWAGER
XP32
Page 19 - 4



SWAGE DIES SUIT XP16
H16 CRIMPERS
DS16
Page 19 - 5

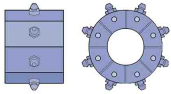

SWAGE DIES SUIT XP20
H20 CRIMPERS
DS20
Page 19 - 6

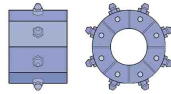

SWAGE DIES SUIT XP32
CRIMPERS
DS32
Page 19 - 7



POWERPACKS
HPP
Page 19 - 8

CUTTING SAWS

CUTOFF SAW
HASC
Page 19 - 8

SWAGER BASES

XP20-QCB

QUICK-CHANGE BASE FOR P20
 FLOOR STANDING BASE AND QUICK-CHANGE DIE RACK

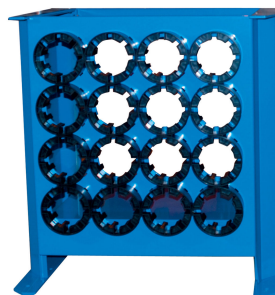

Part Number	Suits number of dies	Includes quick change tool
XP20-QCB	12	Yes

SWAGER BASES

XP32-QCB

QUICK-CHANGE BASE FOR P32
 FLOOR STANDING BASE AND QUICK-CHANGE DIE RACK

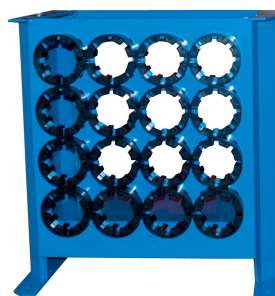

Part Number	Suits number of dies	Includes quick change tool
XP32-QCB	16	Yes

SWAGERS

XP16

FINNPOWER P16 SWAGER
 SWAGER FOR HOSE ASSEMBLIES TO 1 INCH

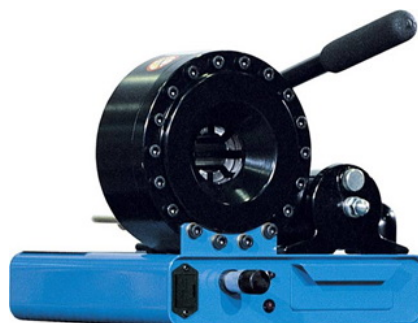

Part Number	Swaging Range	Swaging Force (kN)	Power Source	Swage Control	Length - mm	Width - mm	Height - mm	Weight - kg	Swaging Range (mm)
XP16-AP	10 - 45	955	Air Pump	manual	390	331	271	26	
XP16-HP	10 - 45	955	manual	manual	390	331	271	26	
XP16-HPZ		955	Handpump	Vernier	331	386	271	26	10 - 45

SWAGERS

XP20

FINNPOWER P20 SWAGER
 SWAGER FOR HOSE ASSEMBLIES TO 1 1/4INCH



Part Number	Swaging Range (mm)	Swaging Force (kN)	Power Source	Swage Control	Length - mm	Width - mm	Height - mm	Weight - kg
XP20-CS-12V	10 - 61	1370	12V DC	MS*	571	533	387	83
XP20-CS-24V	10 - 61	1370	24V DC	MS*	571	533	387	83
XP20-MS-1PH	10 - 61	1370	1 Phase	MS*				

SWAGERS

XP32

FINNPOWER P32 SWAGER
 SWAGER FOR HOSE ASSEMBLIES TO 2 INCH



Part Number	Swaging Range (mm)	Swaging Force (kN)	Power Source	Swage Control	Length - mm	Width - mm	Height - mm	Weight - kg	Swaging Range
XP32-MS-3PH	10 - 87	2000	3 phase	MS**	800	630	637	205	
XP32-CS-24V		2000	24V DC	MS*	630	610	425	125	10 - 87

SWAGERS

DS16

SWAGE DIES SUIT XP16 H16 CRIMPERS
 SWAGE DIE SET TO SUIT XP16 H16 CRIMPER

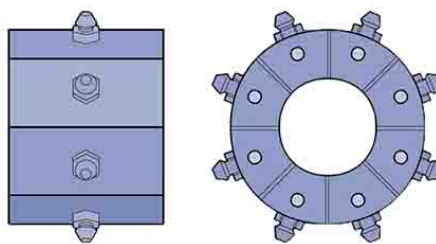

Part Number	Suits crimper	Size range-mm
DS16-10	XP16	10 - 11.9mm
DS16-12	XP16	12 - 13.9mm
DS16-14	XP16	14 - 15.9mm
DS16-16	XP16	16 - 18.9mm
DS16-19	XP16	19 - 22.9mm
DS16-23	XP16	23 - 26.9mm
DS16-27	XP16	27 - 30.9mm
DS16-31	XP16	31 - 38mm
DS16-6	XP16	6 - 7.9mm
DS16-8	XP16	8 - 9.9mm

SWAGERS

DS20

SWAGE DIES SUIT XP20 H20 CRIMPERS
 SWAGE DIE SET TO SUIT XP20 H20 CRIMPER

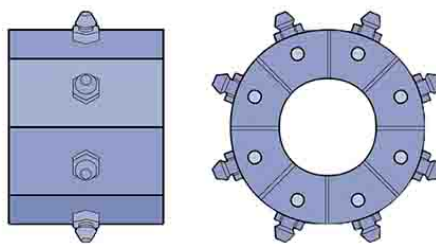

Part Number	Suits crimper	Size range-mm
DS20-10	XP20	10 - 11.9mm
DS20-12	XP20	12 - 13.9mm
DS20-14	XP20	14 - 15.9mm
DS20-16	XP20	16 - 18.9mm
DS20-19	XP20	19 - 22.9mm
DS20-23	XP20	23 - 26.9mm
DS20-27	XP20	27 - 30.9mm
DS20-31	XP20	31 - 35.9mm
DS20-36	XP20	36 - 40.9mm
DS20-41	XP20	41 - 46.9mm
DS20-47	XP20	47 - 53.9mm
DS20-54	XP20	54 - 61mm
DS20-6	XP20	6 - 7.9mm

SWAGERS

DS32

SWAGE DIES SUIT XP32 CRIMPERS

SWAGE DIE SET TO SUIT XP32 CRIMPER

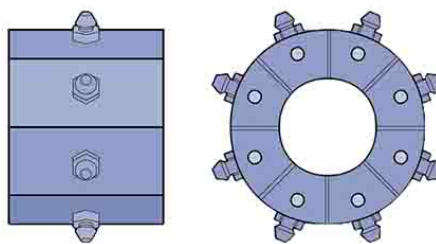

Part Number	Suits crimper	Size range-mm
DS32-10	XP32	10 - 11.9mm
DS32-12	XP32	12 - 13.9mm
DS32-14	XP32	14 - 15.9mm
DS32-16	XP32	16 - 18.9mm
DS32-19	XP32	19 - 21.9mm
DS32-22	XP32	22 - 25.9mm
DS32-26	XP32	26 - 29.9mm
DS32-30	XP32	30 - 33.9mm
DS32-34	XP32	34 - 38.9mm
DS32-39	XP32	39 - 44.9mm
DS32-45	XP32	45 - 50.9mm
DS32-51	XP32	51 - 56.9mm
DS32-57	XP32	57 - 62.9mm
DS32-6	XP32	6 - 7.9mm
DS32-63	XP32	63 - 68.9mm
DS32-69	XP32	69 - 73.9mm
DS32-74	XP32	74 - 77.9mm
DS32-78	XP32	78 - 87mm

SWAGERS

HPP

POWERPACKS

POWER PACK SUIT XP20-AP AND XP20-HPL



Part Number	Voltage - Kw	Pressure	Pump	Tank
HPP-12V	12 volt - 1.6Kw	280 Bar	2.1cc per revolution	6Ltr
HPP-240V	1 phase - 2.2Kw	10000 psi	2.6cc per revolution	10Ltr
HPP-24V	24 volt - 1.6Kw	280 Bar	2.1cc per revolution	6Ltr

CUTTING SAWS

HASC

CUTOFF SAW

CUTOFF SAW WITHOUT BLADE



Part Number	Voltage
HASC-415V	415v